

# Visitor Guide

Welcome to the  
Art Gallery of Nova Scotia

The Art Gallery of Nova Scotia is an inclusive public gathering place that connects people with art to inspire new ways of thinking. Seeking to present the most vital and engaging contemporary art from around the world, we are committed to embracing the past by applying a contemporary viewpoint that addresses relevant issues and challenges perspectives. With nearly 19,000 works in the Permanent Collection, the Art Gallery of Nova Scotia is Atlantic Canada's largest art museum.

## Protect the Art



Please do not touch artworks or consume food and drinks in exhibition spaces.



Large bags, backpacks, umbrellas, and pens are not permitted in exhibition spaces. We offer a complimentary coatroom and secure lockers for your valuables. Please be mindful of your surroundings in exhibition spaces.



Personal photography is permitted, unless otherwise noted, but please turn off your flash as artworks are sensitive to light.

## Accessibility



The Gallery is wheelchair accessible with elevators in both buildings. Service dogs are permitted. The Gallery participates in the Easter Seals Canada Access 2 Card program that offers free admission for the companion of those visitors with permanent disabilities who require assistance.

## Become A Member

Join a community that celebrates culture and diversity through the visual arts.

## Share Your Experience

Follow the Art Gallery of Nova Scotia on social media.

  @ArtGalleryNS

Enjoy your visit!

1723 Hollis Street | Halifax, Nova Scotia | B3J 1V9  
902 424 5280 | agns.info@novascotia.ca

[agns.ca](http://agns.ca)



# Gallery Map

## Level 3 NORTH

Only accessible by elevator.

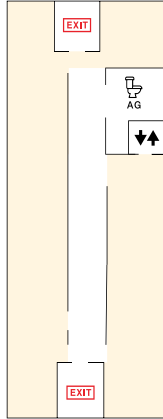

## Building

### North



## Legend

- Exhibition Spaces
- Elevator
- Stairs
- Washrooms
- All Gender Washrooms
- Emergency Exit

## Level 2 NORTH

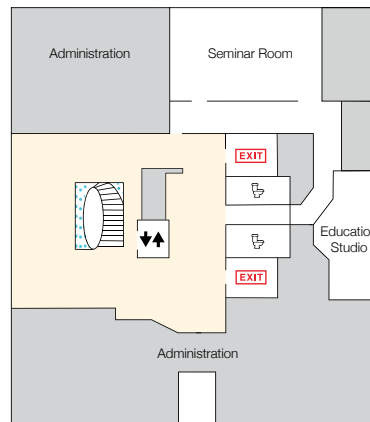
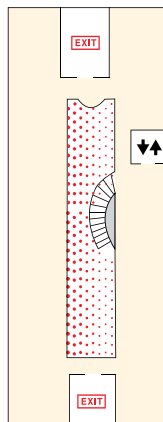

## Level 2 SOUTH

## Level 1 NORTH

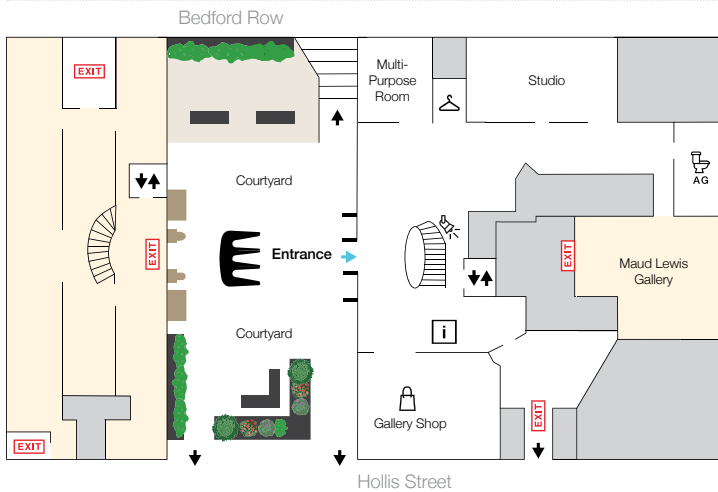

## ENTRANCE

## Level 1 SOUTH

- Courtyard Entrance
- Welcome Desk
- Coatroom
- Nova Scotia Spotlight

## Lower Level

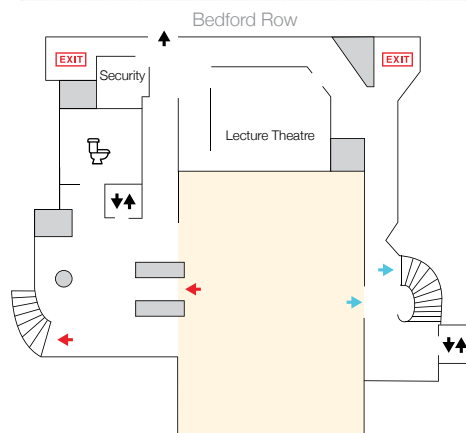

The Art Gallery occupies two buildings, South and North, that are connected by the Lower Level under the Courtyard. Level 3, North is only accessible via the elevator. The exterior elevator signage matches the map and will show you which level you are on.